

Quarter Turn Electric Actuator

VQT Series



VQT Series

Quarter Turn Electric Actuator



- For On-Off and modulation operation.
- 13 sizes with torque from 60Nm to 6000Nm.
- Robust hard anodized aluminium housing epoxy coated.
- Heavy duty squirrel caged induction motor gives high starting torque.
- Dome type easy visibility position indicator.
- Manual override auto declutch mechanism.
- Enclosure IP67 and optional explosion proof Exd IIB T6.
- Anti condensation space heater.
- Auxiliary limit & over torque switches to protect actuator.
- Permanently lubricated for trouble free operation.
- Optional accessories available on request.
- Sales support and back up by our team.

VQT series electric actuator are available from 60 to 6000 Nm torque output. Due to robust design and construction they can be used in most industrial environments. The housing is hard anodized Aluminium Alloy and external epoxy coating paint provides superior resistance for rigorous environments.

The actuator is fitted with a specially designed squirrel cage induction motor to generate high starting torque and is fitted with thermal overload protection to prevent damage from overheating. Included internally are both torque and limit switches for remote indication.

Actuators are supplied standard with manual override and external operating lever that switches the actuator to manual mode. This is automatically disengaged when switched to electrical operation. The gear mechanism is self locking to eliminate the possibility of reverse movement from the valve.

Removable drive bushing allows easy adaption to suit most valve requirements.

Available with a range of optional accessories including extra limit switches, potentiometer, process control unit, local control and signal indication.



VQT Series

Quarter Turn Electric Actuator

Actuator Model	Vavle Conn. ISO5211	Output Torque (Nm)	Power Consumption (W)	Operation Time(S) 50/60Hz	Max. Bore Square◇	Rated Current(A)					No. of Handle Turn	Weight (Kg)
						1Ph 220VAC	1Ph 110VAC	3Ph 380VAC	3Ph 440VAC	24VDC		
VQT-060	F05/F07	60	20	26/22	20	0.45	1.0	0.22	0.26	1.7	10	8
VQT-100	F05/F07	100	20	26/22	20	0.5	1.0	0.22	0.26	1.7	10	8
VQT-160	F07/F10	160	40	28/23	25	0.6	1.45	0.25	0.30	2.0	12	14
VQT-200	F07/F10	200	40	28/23	25	0.6	1.5	0.30	0.35	2.2	12	14
VQT-240	F07/F10	240	45	28/23	25	0.7	1.6	0.35	0.39	2.8	12	14
VQT-350	F10/F12	350	60	32/27	25	0.9	1.8	0.38	0.42	4.0	13	18
VQT-500	F10/F12	500	90	32/27	25	1.3	3.2	0.8	0.86	6.9	13	19
VQT-800	F12/F14	800	120	36/30	38	1.5	3.9	1.1	1.2	9.8	14.5	24
VQT-1100	F12/F14	1100	180	36/30	38	2.2	4.2	1.5	1.6	12.5	14.5	26
VQT-1500	F14/F16	1500	120	110/92	50	1.5	3.9	1.1	1.2	9.8	46	50
VQT-2000	F14/F16	2000	120	110/92	50	1.5	3.9	1.1	1.2	9.8	46	50
VQT-2500	F14/F16	2500	180	110/92	50	2.2	4.2	1.5	1.6	12.5	46	52
VQT-4000	F16/F25/F30	4000	120	180/150	50	1.5	3.9	1.1	1.2	9.8	73	104
VQT-6000	F16/F25/F30	6000	180	180/150	60	2.2	4.2	1.5	1.6	12.5	73	106

Standard Specification

1. Main Power Supply : Standard: 1Ph/220VAC & 3Ph/380VAC
Optional: 1Ph/110VAC, 3Ph 220VAC or 440VAC, 24VAC/24VDC
2. Control Power Supply : 110/220VAC or 24VDC
3. Duty Cycle(on/Off) : S2: 40%~10min
4. Duty Cycle(Modulating) : S4: 25%~600 Start/Hour
5. Motor : Squirrel Caged Induction Motor
6. Limit Switches : 2 x SPST,10A@250VAC at open & closed position
Except VQT-060/100: 1 x SPST,10A@250VAC at open & closed position
7. Torque Switches : 1 x SPST,10A@250VAC at open/closed position(Except VQT-060/100)
8. Stall Protection / Set Temp. : Built - in thermal protection , Open : 150°C & Close : 97°C
9. Position Indicator : Continous mechanical indicator with arrow
10. Mechanical stopper : 1 each for each travel end (open & closed), external & adjustable
11. Self-Locking : Provided by double worm gear (no brake)
12. Manual Override : De-Clutchable
13. Space heater : 5W(110/220VAC) for anti-condensation
14. Cable Entry : 2 x 3/4"NPT
15. Lubrication : EP type grease
16. Terminal block : Screw & lever push type(spring loaded)
17. Amb. Temperature: Standard: -20 ~ 70°C
18. Amb. Humidity : 90%RH Max(No - Condensing)
19. Anti Vibration : XYZ 10g, 02 ~ 34Hz,30 minutes
20. External Coating : Dry Powder(Polyester)
21. Enclosure : Weather-Proof IP67, NEMA 4 & 6.
IP68(option) or EExdIIBT6(option)



VQT Series

Quarter Turn Electric Actuator

Additional Functions for VQT Series Electric Actuator

Code	Function
DI	1). Dome Indicator(VQT-050 is not available)
DP	2). Anti-Condensation Indicator (only available in IP67)
LT	3). -40°C Low Temperature Application
LED	4). GREEN/RED LED Dome Indicator, only available in on/off control type
EX	5). ATEX-Explosion Proof (ExdIIBT6, But ExdIICT6 only available in NTQ-1=060/100/160/200/240)
IP68	6). Water Tight (IP68), not available for LCU function
PCU	7). Modulating control(4-20mADC input/output signal)
CT	8). ON/OFF control with 4-20mADC output signal
LCU	9). Local Control Unit LED indicator(24VDC up to 1000Nm)
LCD	10). The intelligent type with LCD display & Local Control Unit(24VDC up to 1000Nm),IP67/Exd enclosure
FS	11). Battery pack for battery back-up for fail safe
SR	12). Spring Return type for fail safe(4 models output torque:50/100/150/300Nm)
Canbus	13). Canbus protocol communication, with LCD display, only available in 220/380VAC
Mobus	14). Mobus protocol communication,with LCD display,only available in 220/380VAC
Profibus	15). Profibus DP protocol communication,with LCD display, only available in 220/380VAC
Hart	16). Hart protocol communication, with LCD display, only available in 220/380VAC
Blank	17). Option for various voltage motor in 24VAC/24VDC/110VAC/440VAC/220VAC/380VAC

1. With LED Dome Indicator
IP67 enclosure only



2. IP67 enclosure with Local Control Unit & LED indicator



3. Exd enclosure with Local Control Unit & LED indicator



4. With Fail Safe Function
Battery Pack



5. With different Protocol Function
Canbus/Profibus/Mobus



6. Intelligent type, IP67/Exd enclosure.
Local Control Unit & LCD display



VQT Series

Quarter Turn Electric Actuator

Mounting Dimension

Mounting base according to IS05211 standard

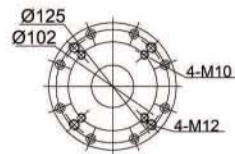
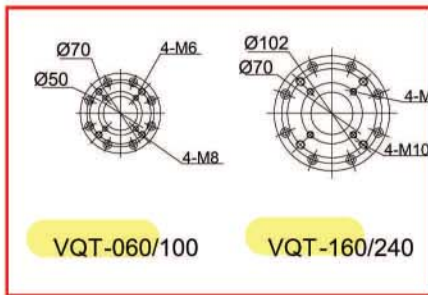

VQT-350/500

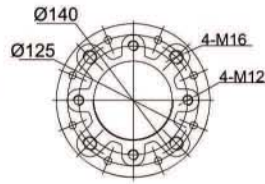

VQT-800/1100

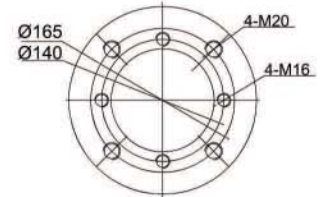

VQT-1500/2000/2500

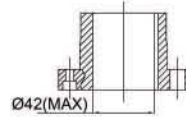
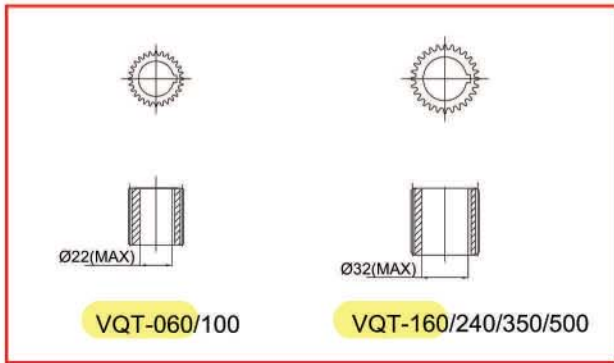

VQT-800/1100

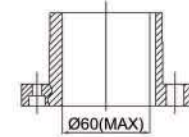
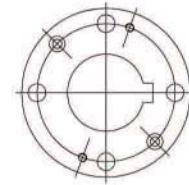

VQT-1500/2000/2500

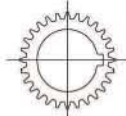
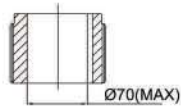
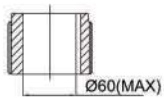

VQT-4000

VQT-6000

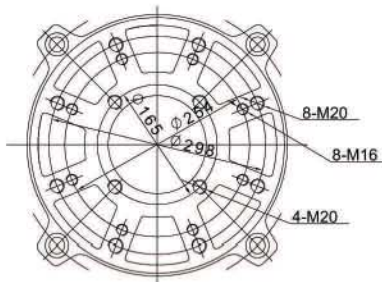

VQT-4000

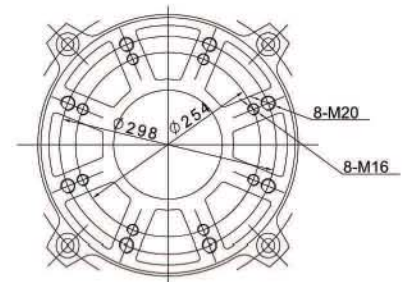

VQT-6000



VQT Series

Quarter Turn Electric Actuator

Ordering Information

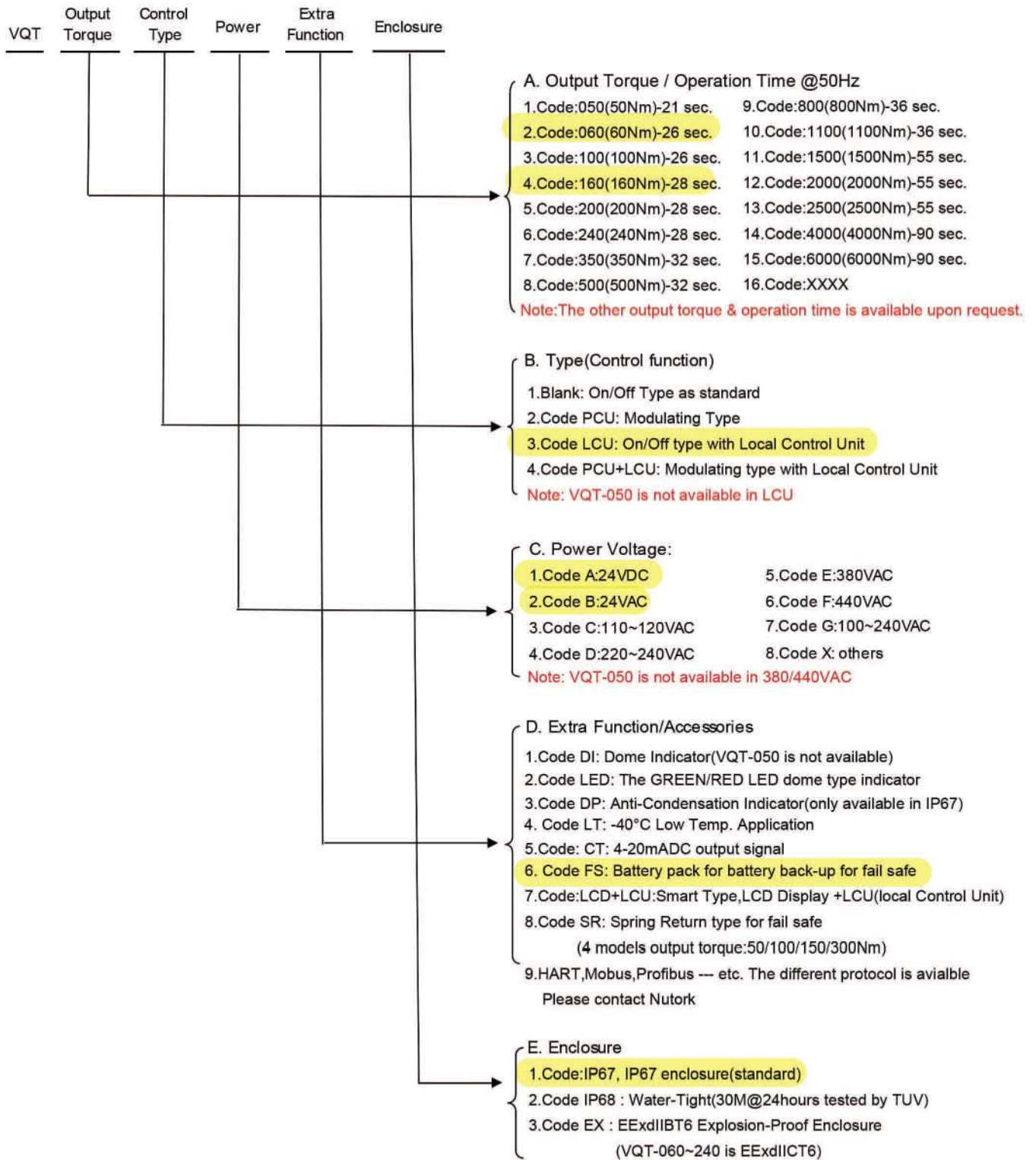

VQT Series

Quarter Turn Electric Actuator

CLINTON TEXOX GROUP. manufactures a wide range of pneumatic actuators, electric actuators and the accessories of pneumatic actuator (limit switchbox, solenoid valve, manual override-etc.) for quarter turn valves



Rack & Pinion Type Pneumatic Actuator.
(Certificated by CE-ATEX/SIL3)
Max. Output Torque: 9340Nm



Scotch Yoke Type Pneumatic & Hydraulic Actuator.
(Certificated by CE-ATEX/SIL3)
Max. Output Torque 293800Nm



VQT Series Electric Actuator
IP67/IP68(30M@24hrs)Enclosure & EExdIIBT6Max. Output Torque 6000Nm
Approved by SIL3/IP68/MD/LVD/EMC.



NTE Series Electric Actuator
IP67/IP68(30M@24hrs)
EnclosureMax. Output Torque 6000Nm
Approved by SIL3/IP68/MD/LVD/EMC.



Limit Switchbox IP67/IP68(50M@72hrs)
Enclosure & EExdIIBT6/EExdIICT6



Solenoid Valve 3/2NC & 5/2 Way, Static O-ring Sealing Design.
Aluminum & 316SS Body
IP67 & EExdIIBT6/EEExdIICT6



Air Filter Regulator Aluminum Body with Vinyl Paint & 316SS Body.
Size: 1/4" ~ 1"



Manual Override Aluminum & Cast Iron & Ductile Iron Body
Max Output Torque 70000Nm



Ball valve (Floating ball design),
We can provide different pressure rating/
connection type/ operation mode.



Concentric Soft Seated Butterfly Valve
High Performance Double Eccentric Butterfly Valve
High Performance Triple Offset Metal Seated Butterfly Valve
We can provide different pressure rating/ connection type/ operation mode.





USA
CLINTON
TEXON
CLINTON TEXON GROUP, USA

Clinton Texon Group LLC
108 West 13th Street Wilmington, DW 19801
United States